

All drawings are for design intent only. It is the contractor's responsibility to check the dimensions, suitability of specifications and compliance with statutory regulations. Sculpt Design Ltd retain the copyright for this drawing which must not be copied, duplicated or distributed without prior written consent. Do not scale from drawing, if in doubt ask!

LEGEND

- fire door type
- push bar on door
- door sign - fire door keep shut
- door sign - fire door keep locked / fail safe digital control
- sign - fire escape keep clear
- illuminated escape sign
- illuminated escape sign with arrow
- automatic smoke detector
- automatic heat detector
- combined automatic heat and smoke detector
- audible warning device
- fire alarm callpoint
- fire extinguisher - dry powder
- fire extinguisher - carbon dioxide
- fire extinguisher - water
- fire extinguisher - multi purpose
- fire blanket
- area covered by emergency lighting

GENERAL NOTES

Consumption of alcohol and licensable activities take place anywhere within the premises
 In the event of fire alarm activation the AV equipment will automatically turn off
 Loose furniture shown indicatively
 All emergency escape alarms, equipment and lighting to conform to current regulations

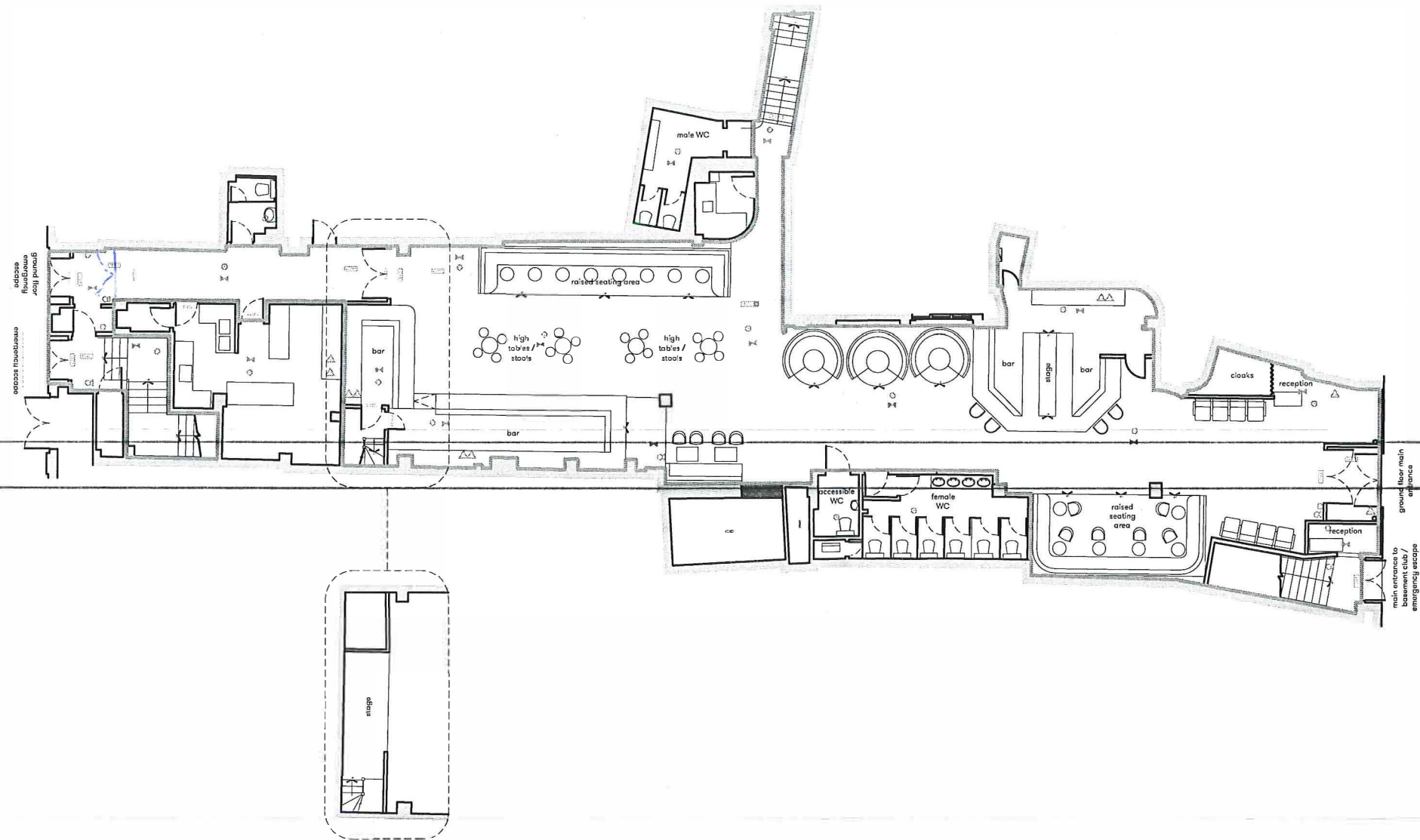

1 Licensing Plan - Ground Floor
 1:200 @ A3

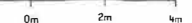

Rev	Date	Comments
D	05.01.2018	FOR LICENSING
C	05.01.2018	FOR LICENSING
B	05.01.2018	FOR LICENSING
A	21.12.2017	FOR LICENSING

Client
 Project Title Bonbanniere Club
 Project Number SC17026
 Project Address
 201 Wardour Street, Soho, London, W1F 8ZH

Drawing Title
 Licensing Plan
 Ground Floor

Drawing Number M(1)02
 Revision D